

DESCRIPTION

Designed for RF power amplifier on HF band mobile radio applications. 80W output power class AB amplifier applications in HF band.

FEATURES

- Specified 12.5V, 30 MHz Characteristics
- $P_o = 80\text{ W min, } 90\text{W typ}$
- $G_p = 12\text{ dB min. at } 80\text{ W}/30\text{ MHz}/12.5\text{ V}$
- Emitter ballasted construction

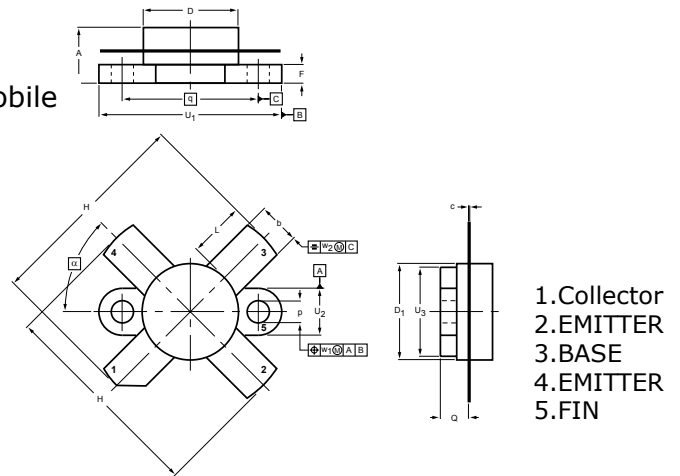

DIMENSIONS

NOTE: ALL ELECTRODES ARE ISOLATED FROM FLANGE.

UNIT	A	b	c	D	D ₁	F	H	L	p	Q	q	U ₁	U ₂	U ₃	w ₁	w ₂	α
mm	7.27	5.82	0.16	12.86	12.83	2.67	28.45	7.93	3.30	4.45	18.42	24.90	6.48	12.32	0.51	1.02	45°
	6.17	5.56	0.10	12.59	12.57	2.41	25.52	6.32	3.05	3.91		24.63	6.22	12.06			
inches	0.286	0.229	0.006	0.506	0.505	0.105	1.120	0.312	0.130	0.175	0.725	0.98	0.255	0.485	0.02	0.04	
	0.243	0.219	0.004	0.496	0.495	0.095	1.005	0.249	0.120	0.154		0.97	0.245	0.475			

MAXIMUM RATINGS

CHARACTERISTICS	SYMBOL	RATINGS	UNITS
Collector-Base Voltage	V_{CB0}	45	V
Collector-Emitter Voltage	V_{CES}	45	V
Collector-Emitter Voltage	V_{CEO}	25	V
Collector Current	I_C	25	A
Emitter-Base Voltage	V_{EBO}	4	V
Collector Power Dissipation	P_{DISS}	275	W
Junction Temperature	T_J	-65 to 175	°C
Storage Temperature Range	T_{STG}	-65 to 175	°C

ELECTRICAL CHARACTERISTICS

CHARACTERISTICS	SYMBOL	TEST CONDITIONS	MIN.	TYP.	MAX.	UNITS
Collector-Emitter Breakdown Voltage	$V_{(BR)CEO}$	$I_C=100\text{mA}, I_B=0$	25	-	-	V
Collector-Emitter Breakdown Voltage	$V_{(BR)CES}$	$I_C=100\text{mA}, V_{EB}=0$	45	-	-	V
Emitter-Base Breakdown Voltage	$V_{(BR)EBO}$	$I_E=5\text{mA}, I_C=0$	4	-	-	V
Collector Cutoff Current	I_{CBO}	$V_{CB} = 12.5\text{V}, I_E = 0$	-	-	10	mA
DC Current Gain	h_{FE}	$V_{CE}=5\text{V}, I_C=5\text{ A}$	20	70	-	
Power Gain	G_p	$V_{CC}=12.5\text{V}, P_{OUT}=80\text{W},$	12	-	-	dB
Collector Efficiency	η_C	$f=30\text{MHz}$	50	-	-	%

Note : Above parameters , ratings , limits and conditions are subject to change.